

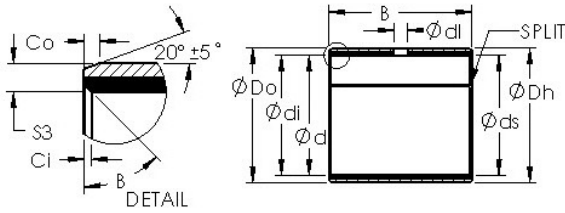

# NTN Mettmann(Deutschland) GmbH



## AST AST40 4040 plain bearings

Bearing No. AST40 4040

Bore Diameter	40 mm
Outer Diameter	44 mm
Bearing Type	straight
Shaft Dia., Nominal (d)	40.0000
Shaft Size (ds) - 40 -0.025 / -0.05	40 0.025 / 0.05
Housing Bore Dia. (Dh)	44 +0.025 / +0
Bearing Outside Diameter, Nominal(Do)	44.000
Bearing Outside Diameter Tolerance (Do tol.)	44.085 / 44.045
Bearing Bore after Mounting (di)	40.085 / 39.99
Average Clearance (Cd)	0.0750
Wall Thickness (S3)	2.005
Bearing Length, Nominal (B)	40.000
Bearing Length Tolerance (B tol.) - +0 / -0.40	+0 / 0.40
OD Chamfer Length (Co)	1.200
ID Chamfer Angle (B deg.)	30
ID Chamfer Length (Ci)	0.500
Material	Steel shell with PTFE / Polymer Fiber lining

AST40 4040 Bearing 2D drawings and 3D CAD models